

Y TYPE STRAINER

Sizes : 1/2" to 14" Nominal Bore

Pressure : ANSI Class 150 LB

Features :

- Integrally Cast Housing
- Bolted Cover C/W Drain Plug
- Red Oxide Finish (Carbon Steel)
- 40 Mesh Screen as Standard

Options :

- Special Gasket, Special Screen
- D.P. Tappings / Gauge
- Magnetic Screen Insert
- Flanged Drains / Drain Valves
- Special Finish / Linings

Standards :

- PED 97 / 23 EC.
- ANSI B16.5 Flange Dimensions
- EN 10204 / NACE Certification

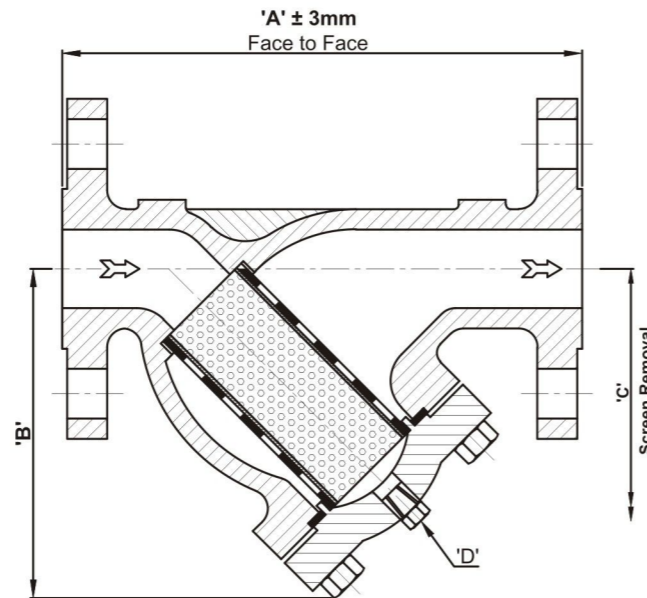

MATERIAL OF CONSTRUCTION

P. NO.	Item	Carbon Steel	Stainless Steel
1	Strainer Body (Cast)	ASTM A216 WCB	ASTM A351 CF8M
2	*Strainer Cover	ASTM A516 Gr. 60 / A216 WCB	ASTM A240 316 / A351 CF8M
3	Drain Plug (Forged)	ASTM A105N	ASTM A 182 F316
4	Cover Studbolts	ASTM A193 B7M - Zinc Plated	
5	Cover Full Nuts	ASTM A194 2HM - Zinc Plated	
6	Cover Gasket (Flat)	C.A.F. as standard / to customer specification	
7	Screen (perforated)	ST. ST. 316 (40 mesh as standard/to customer specification)	

*The strainer cover may be furnished from plate or casting depending upon size/availability.

DIMENSIONS Y TYPE STRAINERS

Inch	MM	'A' Face to Face	'B' Base to Center Line	'C' Screen Removal	'D' Drain (NPT)	Screen Area (cm ²)
1/2"	15	140.0	90.0	150.0	1/2"	78.0
3/4"	20	152.0	100.0	165.0	1/2"	78.0
1"	25	165.0	125.0	215.0	1/2"	82.0
1 1/2"	40	203.0	160.0	285.0	1/2"	157.0
2"	50	229.0	200.0	315.0	1/2"	190.0
3"	80	318.0	270.0	490.0	1/2"	452.0
4"	100	368.0	320.0	500.0	1/2"	743.0
6"	150	470.0	460.0	730.0	1/2"	1456.0
8"	200	597.0	480.0	750.0	3/4"	2565.0
10"	250	673.0	550.0	895.0	3/4"	3923.0
12"	300	775.0	650.0	980.0	3/4"	6033.0
14"	350	850.0	685.0	1070.0	3/4"	7850.0

Note : Weights and dimensions are for reference only.

DUPLEX BASKET STRAINER

Type : Duplex basket filter with 3-way ball valve

Technical Standard

1. In-Out Connection : Class 150 flanged ends RF as per ASME B16.5
2. Body : Fabricated Construction as per material
3. Operating temp. : 35°C

4. Operating Pressure : 5.0 kg/cm²
5. Hydro. Test Pressure : 10.0 kg/cm²

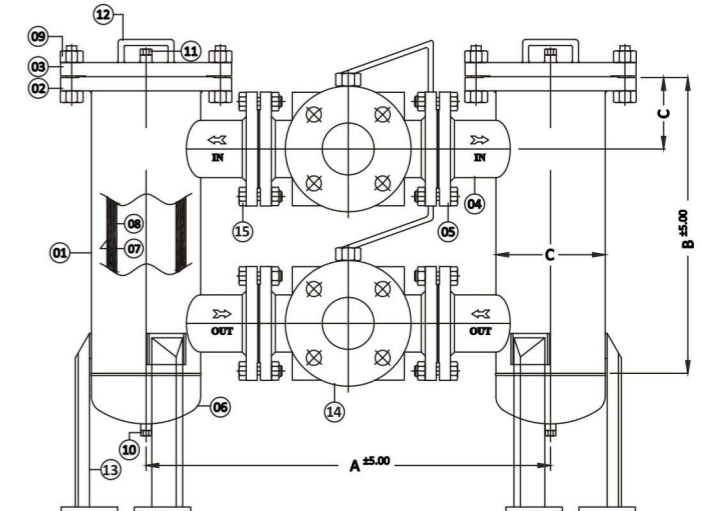

MATERIAL OF CONSTRUCTION

SR. NO.	Item Description	Carbon Steel	Stainless Steel
1	Shell	IS 1239/IS 3589/SA 106	SS 304, SS 316
2	Shell Flange	IS 2062/SA 105	SS 304, SS 316
3	Cover Flange	IS 2062/SA 105	SS 304, SS 316
4	In-Out Nozzle	IS 1239/SA 106	SS 304, SS 316
5	Nozzle Flange	IS 2062/SA 105	SS 304, SS 316
6	Dishend	IS 2062/SA 234 Gr. WPB	SS 304, SS 316
7	P Sheet	SS 304, SS 316 (Ø6mm Hole)	
8	Wire Mesh	SS 304, SS 316 (40 Mesh)	
9	Stud & Nut	IS 1367/ASTM A 193 Gr. B7/2H	SS 304/ASTM A 193 Gr. B7/2H
10	Drain Plug	M.S. / SA 105	SS 304, SS 316
11	Vent Plug	M.S. / SA 105	SS 304, SS 316
12	Handle	M.S.	SS 304
13	Leg Support	M.S.	SS 304
14	3-Way Ball Valve (L-port)	SA 216 Gr. WCB (SS 304 Ball)	SA 351 Gr. CF8/CF8M (SS 304, SS 316 Ball)
15	Stud & Nut	IS 1367/ASTM A 193 Gr. B7/2H	SS 304 / ASTM A 193 Gr. B7/2H

- Note : • We are continuously improving our product. Also other material on request by client.
 • We reserve the right to change detail without prior notice. • All dimensions are in mm. if not specified.

DIMENSIONS DUPLEX BASKET STRAINER

Inch	MM	'A' Face to Face	'B' Top to Bottom Line	'C' Top to Nozzle Line	'ØD' Shell Dia.	'E' Screen Removal	Basket Area (CM ²)
1	25	490.0	360.0	120.0	4"	270.0	588.0
1 1/2"	40	560.0	480.0	135.0	4"	320.0	915.0
2"	50	590.0	500.0	150.0	5"	320.0	950.0
3"	80	710.0	605.0	150.0	6"	460.0	1467.0

Note : Weights and dimensions are for reference only.